

Quick Guide RatTrap

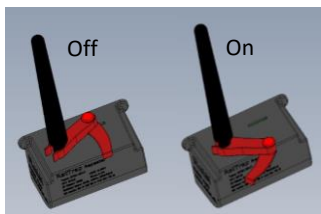

Remember the rules for ATEX-labeled equipment - please refer to the manual

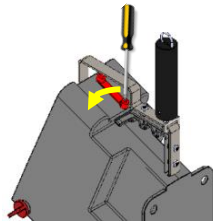
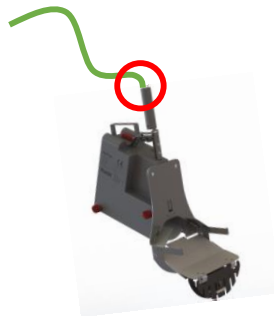
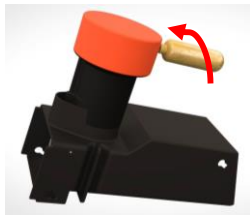

Preparation:

- Insert the CO2 canister
- Secure the wire to the trap
- Select and mount the inlet
- Prepare the electronics
- Configure the trap in the app

Mounting in concrete manhole

- Determine need for a guide rod
- Position mounting kit (and guide rod)
- Mount the trap
- Lock the wire and fabric cord
- Test the system

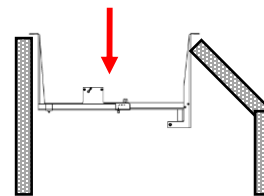
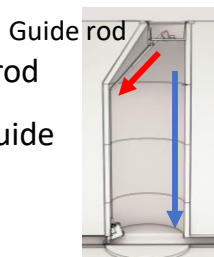

Magnet is passed over communications module

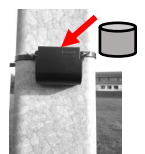

Mounting in PVC manhole

- Position mounting kit
- Mount the trap
- Lock the wire
- Test the system

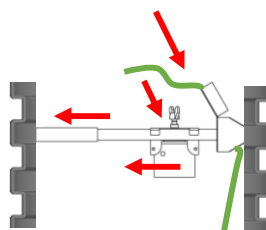

Magnet is passed over communications module

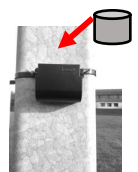

Quick Guide RatTrap

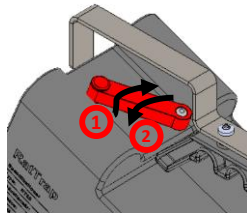
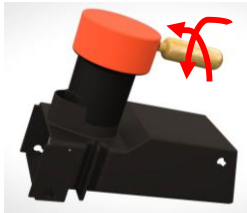

Service

- Demount the trap
- Change the CO2 canister
- Reset the kill counter
- Note it in the app
- Mount the trap

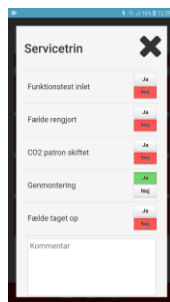
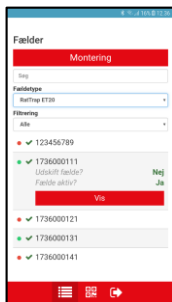

Relocating a trap

- Demount the trap and mounting kit
- Place magnet in repeater - use tape
- Deactivate transmitter in the trap
- Demount communications module
- Demount the trap in the app
- And all in reverse on the new site.....

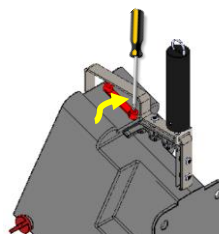
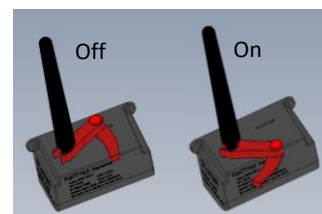

Replacement of the outer container or killing device

- Demount the trap
 - Replace the outer container
- or
- Replace the killing device without further action
 - Mount the trap

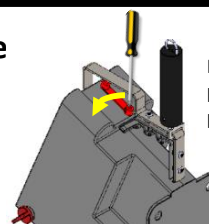

New unit is activated as per general preparation

The "Replace" function in the service menu in the app is used

